



MasterShift

Installation Instructions

U.S. Patent No. RE 25,561 & 3,052,135

ATTENTION

Due to variations in auto manufacturing tolerances, the transmission rods supplied with this kit may require slight bending to clear obstructions, etc. Protect the threads while bending. BEND RODS COLD! - DO NOT APPLY HEAT!

HURST TUNNEL KIT
Pt. 264 4790
MAY BE USED TO CLOSE
OPENING IN FLOOR

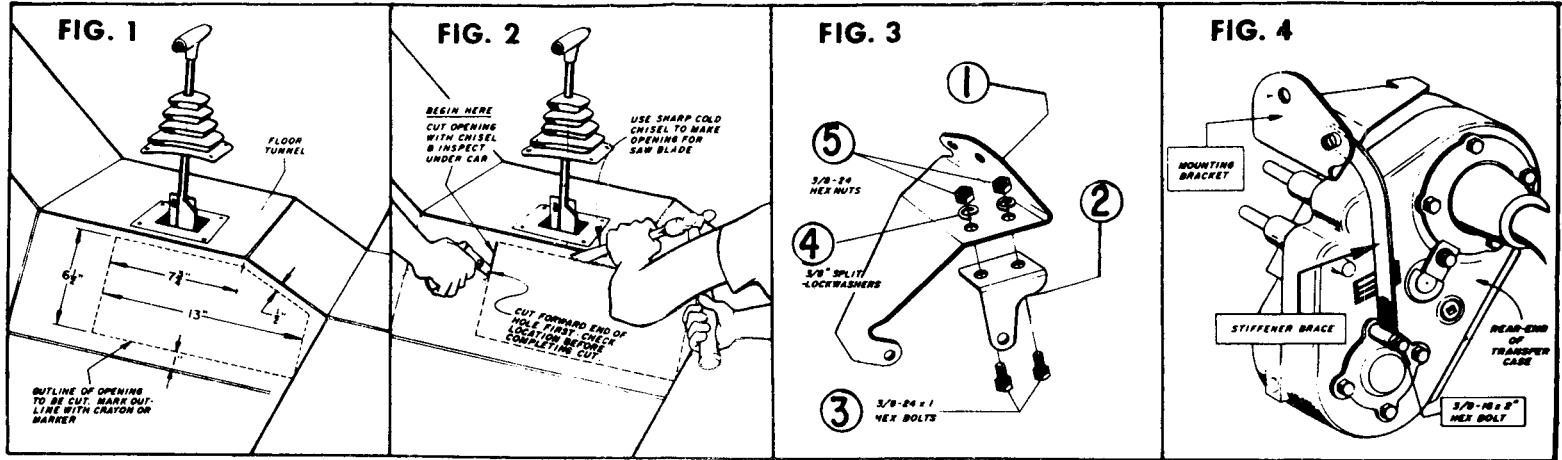

CONTENTS OF KIT

- | | |
|-------------------------------------|------------------|
| 1. MOUNTING BRACKET | Pt. 117 0007 |
| 2. BRACKET LEG | Pt. 117 4777 |
| 3. 3/4 - 24 x 1 HEX HEAD CAP SCREW | (2) |
| 4. 3/8" SPLIT LOCKWASHER | (3) |
| 5. 3/8 - 24 HEX NUT | (2) |
| 6. 3/8" FLATWASHER | (6) |
| 7. STIFFENER BRACE | Pt. 116 0004 |
| 8. 3/8 - 16 x 2 HEX HEAD CAP SCREW | |
| 9. 7/16 - 14 x 3 HEX HEAD CAP SCREW | |
| 10. 7/16" FLATWASHER | |
| 11. 7/16" SPLIT LOCKWASHER | |
| 12. 7/16 - 14 HEX NUT | |
| 13. 3/8 - 16 x 3 HEX HEAD CAP SCREW | |
| 14. 3/8" INT/EXT TOOTH LOCKWASHER | |
| 15. 3/8 - 16 HEX NUT | |
| 16. BACK-UP LIGHT SWITCH BRACKET | Pt. 117 0006 |
| 17. ROD ADJUSTING BUTTON | Pt. 119 3783 (2) |
| 18. BUSHING | Pt. 118 3311 (4) |
| 19. SPRING CLIP | Pt. 97000015 (4) |
| 20. ARM 1st - REV. | Pt. 105 4746 |
| 21. ROD 1st - REV. | |
| 22. ARM 2nd - 3rd | Pt. 213 4742 |
| 23. ROD 2nd - 3rd | Pt. 213 0062 |
| | Pt. 105 4747 |
| | Pt. 213 4741 |
| | Pt. 213 0063 |
| 24. SHIFTER | Pt. 366 0001 * |
| 25. STICK | Pt. 238 6900 |

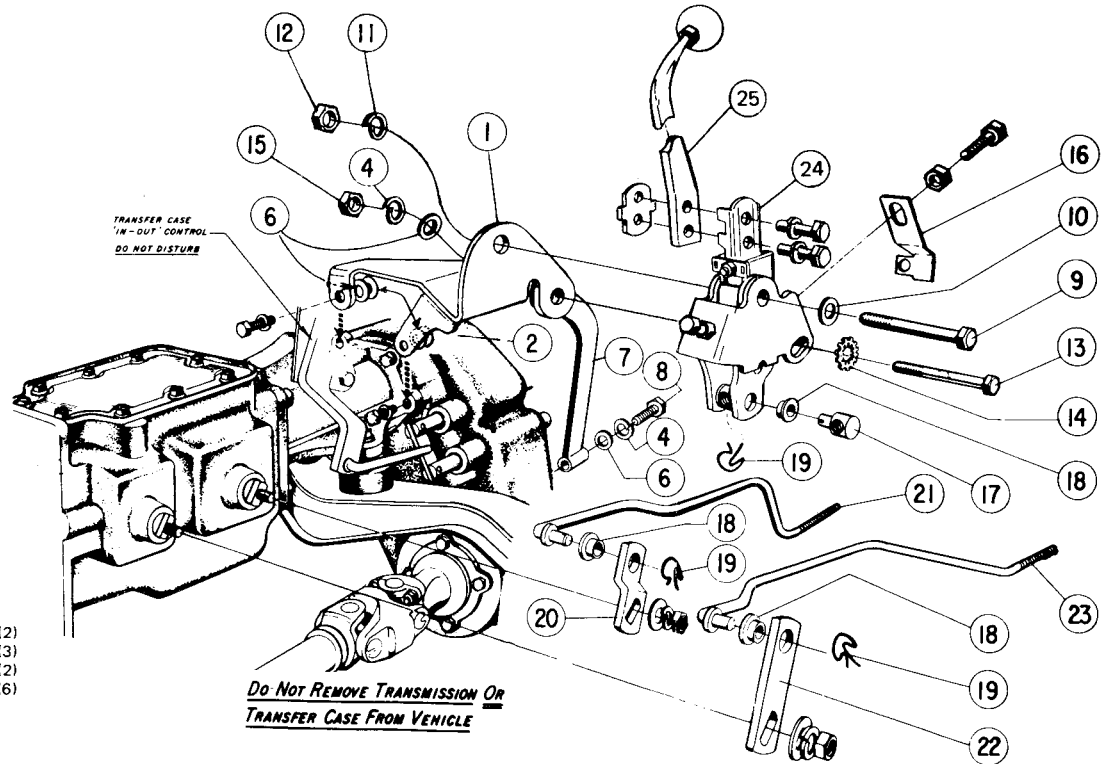

367 0013

BAGGED HARDWARE Pt. 154 0025

*These two parts, when combined, are sold as Hurst Pt. 366 6901.